

AutoCAD® Civil 3D® 2013

Autodesk Certification

Exam Preparation Roadmap

Autodesk certifications are industry-recognized credentials that can help you succeed in your design career—providing benefits to both you and your employer.

The certifications provide reliable validation of skills and knowledge, and they can lead to accelerated professional development, improved productivity, and enhanced credibility.

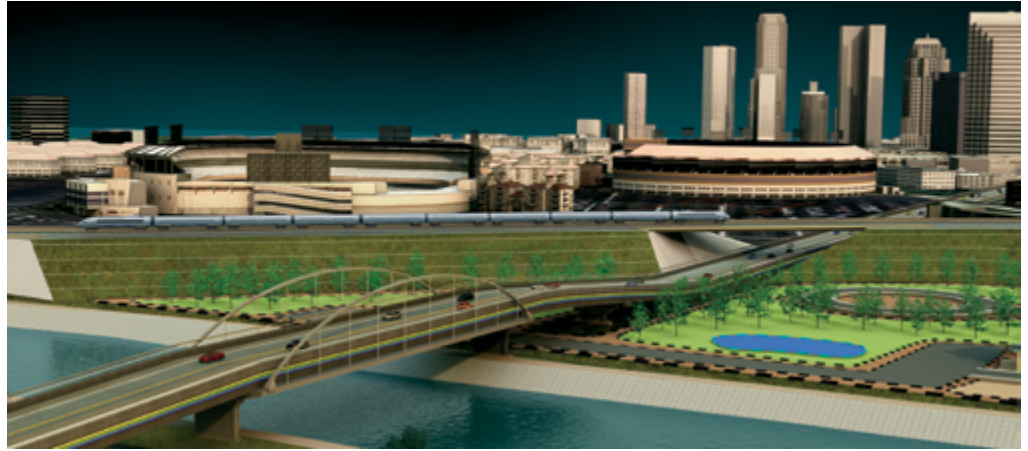

Autodesk highly recommends that you structure your examination preparation for success. This means scheduling regular time to prepare, reviewing this exam preparation roadmap, using the Autodesk Official Training Guides, and taking a course at one of our Authorized Training Centers. Equally as important, actual hands-on experience is recommended.

The **AutoCAD Civil 3D 2013 Certified Professional** exam is a performance-based test aimed at assessing Professional users' knowledge of the tools, features, and common tasks of AutoCAD Civil 3D 2013.

The exam is comprised of 35 questions, of which the majority require you to use AutoCAD Civil 3D 2013 to create or modify a data file, and then type your answer into an input box. Other question types include multiple choice, matching, and point-and-click (hotspot).

The exam has a 2-hour time limit (in some countries, the time limit may be extended).

Important Program Changes

The Certified Associate exam will not be made available for AutoCAD Civil 3D 2013.

To obtain the status of AutoCAD Civil 3D 2013 Certified Professional, or when recertifying from 2012 Associate and/or 2012 Professional status, you must pass the AutoCAD Civil 3D 2013 Certified Professional exam.

You may take the exam up to three times within a 12-month period.

Official Preparation Material

The **Autodesk Official Training Guides** for the AutoCAD Civil 3D Certification exam are published by Ascent and Wiley Publishing. The Guides are available from booksellers and online booksellers worldwide.

ATC® Instructor-Led Courses

The Autodesk Authorized Training Center (ATC®) program is a global network of professional training providers offering a broad range of learning resources. Autodesk recommends that test takers consider taking a certification preparation course at one of these centers. Visit the online ATC locator at <http://www.autodesk.com/atc>

Recommended Experience Levels

Actual hands-on experience is a critical component in preparing for the exam. You must spend time using the product and applying the skills you have learned.

- **2013 Certified Professional exam:**
AutoCAD Civil 3D 2013 course (or equivalent) plus 400 hours of hands-on application

AutoCAD Civil 3D 2013

Exam Topics and Objectives

We recommend that you review the topics and objectives during your preparation for certification. The Autodesk Official Training Guides for the AutoCAD Civil 3D Certification exams are published by Wiley Publishing and Ascent. These guides cover the topics and objectives listed below. Please note that not all objectives will be tested during your certification exam.

AutoCAD Civil 3D 2013 Certified Professional

| Topics | Objectives |
|---------------------------|--|
| User Interface | Navigate the user interface Use the functions on the Prospector Tab Use functions on the Settings Tab |
| Styles | Create and use object styles Create and use label styles |
| Lines & Curves | Use the line and curve commands Use the Transparent command |
| Points | Create points using the Point Creation command Create points by importing point data Use point groups to control the display of points |
| Surfaces | Create and edit surfaces Use styles and settings to display surface information Create a surface by assembling fundamental data Use styles to analyze surface display results |
| Parcels | Create parcels using parcel layout tools Design a parcel layout Select parcel styles to change the display of parcels Select styles to annotate parcels Create alignments |
| Alignments | Design a geometric layout |
| Profiles & Profile Views | Create a surface profile Design a profile Create a layout profile Create a profile view style Create a profile view |
| Corridors | Design and create a corridor Derive information and data from a corridor Design and create an intersection |
| Sections & Section Views | Create and analyze sections and section views |
| Pipe Networks | Design and create a pipe network |
| Grading | Design and create a grading model Create a grading model feature line |
| Managing and Sharing Data | Use data shortcuts to share/manage data Create a data sharing setup |
| Plan Production | Generate a sheet set using plan production Create a sheet set |
| Survey | Use description keys to control the display of points created from survey data Use figure prefixes to control the display of linework generated from survey data Create a boundary drawing from field data |

For more information
<http://www.autodesk.com/certification>
Find an Autodesk Certification Center
<http://autodesk.starttest.com>

Autodesk, AutoCAD, and Civil 3D are registered trademarks or trademarks of Autodesk, Inc., and/or its subsidiaries and/or affiliates in the USA and/or other countries. All other brand names, product names, or trademarks belong to their respective holders. Autodesk reserves the right to alter product and services offerings, and specifications and pricing at any time without notice, and is not responsible for typographical or graphical errors that may appear in this document.

© 2012 Autodesk, Inc. All rights reserved.